

**CELEBRATING  
ACHIEVEMENTS  
IN AGGREGATE**



# **2017 OSSGA INDUSTRY ADVANCEMENT & STUDENT DESIGN AWARDS**



## AWARD OF EXCELLENCE

The Award of Excellence is the highest honour an active site can achieve in the OSSGA Industry Recognition Awards Program. The award signifies outstanding and continued achievement in all aspects of an aggregate operation. It is given to an aggregate pit or quarry that has already earned the Progressive Rehabilitation Award, the Community Relations Award and the Property Enhancement Award (including all seven "gold" bars). The recipients of this award are producers that go above and beyond industry standards in all these areas of consideration.



### **LAFARGE CANADA INC.** **A Member of LafargeHolcim** WOODSTOCK QUARRY TOWN OF ZORRA

Lafarge's Woodstock Quarry has demonstrated leadership in community relations, property enhancements, and site rehabilitation. The quarry participates in tree planting events, contributes to local groups, conducts tours for students and community members, and volunteers and raises funds for Woodstock's Domestic Abuse Centre. Its on-site achievements include a traffic light crosswalk for pedestrians, an upgraded entrance, and a daylight traffic triangle, which keep the site safe and attractive. Preventative maintenance and noise and dust control measures keep its operations from having a negative impact on neighbours. Lastly, Woodstock Quarry has been recognized by OSSGA's Awards program for the progressive rehabilitation of the 550-hectare site, which recently began focusing on the final extraction faces.

### **WALKER AGGREGATES INC.** MCGREGOR QUARRY TOWN OF AMHERSTBURG

McGregor Quarry has won multiple awards for its community relations, progressive rehabilitation, and property enhancement. In recent years, it installed an automatic front gate, paved areas to reduce dust, and upgraded site signage. It also maintains berm plantings and trees along its perimeter and continuously invests in keeping its equipment and work zones clean and safe. About 12.88 hectares of its 126.65-hectare site have been rehabilitated and McGregor Quarry is also committed to building strong community ties. It sponsored the Town of Amherstburg's Canada 150 Canuck it Up! festival and the Annual Essex Region Conservation Golf Tournament, and regularly supports numerous charities and local events. Its staff host barbecues, tours, and class presentations, and they connect with neighbours through the Walker Brothers website and newsletter.



### **WALKER AGGREGATES INC.** WALKER BROTHERS QUARRIES TOWNSHIP OF STAMFORD (NIAGARA FALLS)

This original Walker family quarry is home to the Walker Industries' head office and a welcome fixture in the Niagara Falls region. It has won multiple Community Relations Awards for its efforts to minimize its impact on neighbours. Recent improvements included adding more polyurethane screens in the plant, purchasing a new water truck, installing electronic radar signage, and creating a new traffic plan. The quarry gives back to the community through open houses and educational events, donations and support for charitable initiatives like Habitat for Humanity, the Parkinson SuperWalk and the All Sports All People's sledge hockey program. Its rehabilitation efforts include building the scenic Ten Mile Creek Trail and creating an entire ecosystem that is home to a variety of native plants and animals.





# BIODIVERSITY



The Biodiversity Award honours OSSGA members for their contribution to sustaining biodiversity through species protection, habitat improvement and sustainable land-use activities. They are recognized for conserving biodiversity beyond standard regulatory practices and typical industry activities. Each eligible project must demonstrate support for one or more of the following: engaging people, reducing threats, enhancing resilience, and improving knowledge.



## **LAFARGE CANADA INC. – A Member of LafargeHolcim** ORO-MEDONTE CLUSTER (ROEHNER, NORMAN, AND GREEK PITS) TOWNSHIP OF ORO-MEDONTE

Lafarge leverages tools like its Biodiversity Management Plan (BMP) and the International Union of Conservation of Nature's Biodiversity Indicator and Reporting System (BIRS) to enhance and protect biodiversity at its Oro-Medonte Pits (Roehner, Norman, and Greeks Pits). It is guided by the four strategic directions outlined in Ontario Biodiversity Strategy, 2011. It engages people through site tours and educational events and improves knowledge through awareness campaigns as well as tree planting events with groups like the Boys and Girls of Innisfil and Scouts Canada. Lafarge's biodiversity strategy supports at-risk species, makes new linkages to surrounding ecosystems through ongoing rehabilitation, and creates new habitats.

## A SPECIAL THANKS TO THE JUDGES

*The Industry Awards Review Panel was comprised of judges invited from outside the industry, including Michael Williams, Ducks Unlimited Canada; Sue Foxton, Mayor of North Dumfries; Nicholas Schulz, Cornerstone Standards Council; Sara Wilbur, Grand River Conservation Foundation; and James Bakker, MNRF Acting Aggregate Resources Coordinator. They were supported by OSSGA members Kevin Fitzpatrick of*

*WSP Canada Inc. and Danielle Solondz of The Ontario Aggregate Resources Corporation (TOARC).*

*The Biodiversity Award Review Panel included Steve Hounsell, Chair of the Ontario Biodiversity Council; Lynette Mader, Manager of Provincial Operations - Ontario for Ducks Unlimited Canada; and Nigel Finney, Watershed Restoration Planner with Conservation Halton.*

*The Student Design Award Review Panel was comprised of members from outside the industry, including Stephen Douglas, an MNRF Aggregates Inspector, as well as members of OSSGA's Rehabilitation and Species at Risk Committees: George Antoniuk, The Miller Group; Kevin Fitzpatrick, WSP Canada Inc.; Debra Kakaria, MHBC Planning; Luke McLeod, Lafarge Canada Inc.; and Greg Sweetnam, James Dick Construction Ltd.*





# COMMUNITY RELATIONS

SUPPORTED BY

**Hellingman**  
COMMUNICATIONS INC

[www.hellingman.com](http://www.hellingman.com)

The Community Relations Award recognizes those who have demonstrated leadership in promoting good neighbour relations, community involvement, education, and industry awareness.



## CAPITAL PAVING INC.

WELLINGTON PIT  
TOWNSHIP OF PUSLINCH

From a traffic safety program to neighbour feedback programs, Wellington Pit strives to be a positive member of its community. In 2017, Capital Paving became a major sponsor of the Sunrise Therapeutic Riding and Learning Centre in Puslinch, committing to donating materials, equipment, transportation, and labour for its renovation. Wellington Pit employees volunteer in local school initiatives, food drives and fundraisers, including the Canadian Cancer Society's Hope and the City event in Guelph. The Pit builds industry awareness through site tours, a newly designed website and newsletter, an active social media presence, and by supporting the Conestoga College Institute of Technology and Advance Learning's Heavy Equipment Operator program.

## CBM AGGREGATES A Division of Votorantim Cimentos

ABERFOYLE PIT  
CITY OF CAMBRIDGE

Being a good neighbour is a top consideration for CBM Aggregates' Aberfoyle Pit. Its team works daily to minimize site noise, dust, and safety risks, engages neighbours through open houses, and conducts site tours for student groups, industry associations, and local organizations like the GRCA Mill Creek Stewardship Rangers. Aberfoyle Pit hosts tree planting events, police and fire department training, and educational programs. The pit regularly contributes material to local events, including the Aberfoyle Fall Fair. It posts updates and operational news on the CBM Aggregates website, and recently started holding public consultations on the opening of its Roszell Pit.



## CBM AGGREGATES A Division of Votorantim Cimentos

CODRINGTON PIT  
CODRINGTON

Taking measures to reduce noise, control dust, and keep its roads safe is just the tip of Codrington Pit's community relationships strategy. This summer, the pit donated funds to support the Codrington Farmers' Market Food Tasting event, and in the fall it supported the Chef Tour and Cooking Demo. CBM Aggregates also donated \$15,000 towards paving for the Codrington Community Centre. It keeps the public informed through its website, the pit's Community Liaison Group (CLG), and site tours for local leaders and groups. Recently, the Codrington team hosted over 100 neighbours for a community open house.





## CBM AGGREGATES A Division of Votorantim Cimentos SUNDERLAND PIT TOWN OF BROCK

CBM Aggregates uses berms, tree screens, and strategic trucking schedules to minimize noise, while controlling dust with paved entries and an on-site water truck. It employs signage, speed limits, and strict traffic laws to keep its roads safe. Its Sunderland Pit has been a title sponsor of the Annual Brock Township Charity Golf Tournament for 12 years running and it annually donates sand to the Sunderland Lions Club Beach Volleyball Tournament. CBM Aggregates recently joined Forest Ontario to plant 20,000 trees across 25 acres at the Sunderland Pit and regularly leads online and in-person communications, open houses, educational initiatives (with Forest Ontario), and site tours for students at its Sunderland Pit.



## DUFFERIN AGGREGATES A Division of CRH Canada Group Inc. ACTON QUARRY TOWN OF HALTON HILLS

Acton Quarry's Community Engagement Plan includes regular consultations with local stakeholders, on-site noise, dust, and traffic measures, and monetary and in-kind donations to over 20 non-profit and community groups. It hosts an annual Earth Week Celebration with Scouts Canada and recently partnered with the Darling Home for Kids, Dufferin Aggregates Milton Quarry, Sovereign Fusion, and Battlefield to build a trail on the property that gives children better access to the surrounding woods. Added to these efforts is the Dufferin Aggregates/ CRH Canada Ready-Mix Drum Sponsorship Program, regular site tours, an annual open house, and the work of its Community Advisory Panel.

## DUFFERIN AGGREGATES A Division of CRH Canada Group Inc. CARDEN QUARRY VILLAGE OF BRECHIN

Dufferin Aggregates' Carden Quarry takes ongoing measures to minimize noise and dust. It installed a CPL noise reduction system and upgraded to a larger water truck, adding spray bars to improve dust suppression. The quarry takes proactive measures to monitor its water taking and keeps quarry roads safe with its Dufferin Aggregates' Truck Safety Policy. Carden Quarry regularly donates funds and materials to local events and organizations, such as the Couchiching Conservancy Passport to Nature Festival, the Ramara Chamber Car Show, and a number of golf tournaments. It also established a neighbour load donation plan and contributed material towards the Centennial Park Beach Rehabilitation Project.



## DUFFERIN AGGREGATES A Division of CRH Canada Group Inc. MILTON QUARRY TOWN OF MILTON

For Dufferin Aggregates' Milton Quarry, building good relations starts with an extensive blast monitoring and communication strategy, as well as measures to reduce noise, minimize dust, and negate traffic risks. The quarry also hosts annual tree planting events, site tours, and open houses, and contributes to sports groups, non-profit organizations, and other local initiatives. In 2017, it participated in the Dublin Line cleanup, raised funds for the Chamber of Commerce's annual Scholarship Program and Golf Tournament, and helped extend a wheelchair accessible nature path at the Darling Home for Kids.



## **DUFFERIN AGGREGATES** **A Division of CRH Canada Group Inc.**

**MOSPORT PIT**  
**TOWN OF ORONO**

Significant noise and dust control measures are taken at Dufferin Aggregates' Mosport Pit, and road safety is strictly enforced through a site traffic plan. The pit holds regular communication sessions, open houses, site tours, and awareness events such as its Zero Harm / Safety Day. It provides updates through its Environmental Management System (EMS) and the Dufferin Aggregates' Corporate Social Responsibility Committee. In 2017, Mosport Pit donated around \$5,000 in monetary and material donations to local charities, organizations, and community events, including the Orono Santa Claus Parade and the In the Face of An Angel Golf Tournament for Ovarian Cancer.



## **DUFFERIN AGGREGATES** **A Division of CRH Canada Group Inc.**

**PARIS PIT**  
**TOWN OF PARIS**

Dufferin Aggregates employs numerous noise, dust, and traffic control measures at its Paris Pit to minimize its operation's impact. It donates volunteers, materials, and funds to local sports teams and organizations, including the Paris Agricultural Society, Brant United Way, and the Paris High School. It has also paired with different groups for on-site tree planting initiatives. These efforts are communicated through the Paris Pit's Community Advisory Panel (CAP), which provides a forum for community members to discuss issues like water taking and rehabilitation plans. The information is then shared on the corporate website and through social media channels.

## **WALKER AGGREGATES INC.**

**DUNTROON QUARRY**  
**TOWN OF DUNTROON**

Duntroon Quarry goes to great lengths to be a good neighbour, be it upgrading equipment to reduce noise and dust, using Explotech to monitor blasting activities, or employing a retired police officer to enhance traffic safety. The quarry donates stone to organizations like Habitat for Humanity and the Collingwood Agricultural Society. It is a platinum sponsor of the Feversham Fall Fair, a sponsor of the Stayner Siskins Hockey Club, and hosts research students from the University of Waterloo. The quarry holds Public Liaison Committee summer barbecues and Holiday Wine and Cheese receptions, publishes a StoneViews newsletter, and recently joined Walker Aggregates in promoting the aggregate industry with a colouring book for children.



## **WALKER AGGREGATES INC.**

**MCGREGOR QUARRY**  
**TOWN OF AMHERSTBURG**

Beyond taking measures to minimize the impact of its operations, McGregor Quarry conducts site tours, holds community barbecues and public meetings, and takes part in public outreach programs. It donates stone to initiatives like Habitat for Humanity and provides financial support for the Town of Amherstburg's Canada 150 Canuck it Up! festival, the 29th Annual Essex Region Conservation Foundation Golf Tournament, and other fundraisers. As well, the quarry provides donations and highly discounted products to the Essex Region Conservation Authority (ERCA) for vital projects in the region. These initiatives are conveyed through the quarry's BorderStones newsletter and the Walker Aggregates' website.



**WALKER AGGREGATES INC.**RIDGEMOUNT QUARRIES  
TOWN OF FORT ERIE

Ridgemount Quarries works hard to keep its reputation within Fort Erie strong. On-site, it conducts regular maintenance to minimize noise and dust and employs a traffic enforcement officer to oversee road safety. In 2016, it replaced one of its main bridges to enhance site safety and improve aesthetics. In 2017, it donated over 70 tonnes of stone to Habitat for Humanity, while regularly supporting local sports groups and charitable initiatives. The quarry holds on-site educational tours, and hosts unique activities such as an archaeological dig by Paleo Joe and filming for a History Channel movie. It was also involved in the distribution of a Walker Aggregates' colouring book for children.

**WALKER AGGREGATES INC.**VINELAND QUARRIES & CRUSHED STONE  
TOWN OF VINELAND

Vineland Quarries & Crushed Stone has a comprehensive traffic monitoring system, conducts advanced Explotech blast monitoring, uses soundproof enclosure systems to manage noise, and watering trucks and customized industrial tarps to suppress dust. It keeps neighbours involved through Public Liaison Committee Holiday Wine and Cheese receptions, open houses, newsletters, and online communications. Giving back is part of the quarry's mission: it has donated stone to the Bethesda Group Living Facility, Niagara Shorthills Christian Ministries, and Camp Wetaskiwin, among others. Quarry staff also hold food drives and host the Vineland Scouts for their Earth Day Cleanup.

**WALKER AGGREGATES INC.**WALKER BROTHERS QUARRIES  
TOWNSHIP OF STAMFORD (NIAGARA FALLS)

Advanced blast monitoring, site upgrades, and neighbour consultations are all part of Walker Brothers Quarries' community relations strategy.

The company donates stone to Habitat for Humanity and Thorold's Sullivan Park projects. It also leads fundraisers for local sports groups and charitable causes, such as Karter's Smile Crusade, and sponsors the Earth Rangers youth conservation organization. The quarry promotes neighbour feedback through its Public Liaison Committee Holiday Wine and Cheese reception and site tours. It also opens its site to students to learn about the aggregate industry and Walker's role within it.







# PROGRESSIVE REHABILITATION

SUPPORTED BY



The Progressive Rehabilitation Award recognizes ongoing efforts of individual operators in progressively rehabilitating their sites in accordance with their site plans.

## CBM AGGREGATES – A Division of Votorantim Cimentos

### JUDGES' CHOICE AWARD

LIMEHOUSE PIT  
TOWN OF HALTON HILLS

Rehabilitation on CBM Aggregate's Limehouse Pit targeted 1.75 hectares on its southeast corner. The rehabilitation was carried out from September to mid-November 2016, with plans to make a small lake via below water table excavation over 0.25 hectares. The project included contouring the land with a minimum of 30 centimetres topsoil over the dry portion, with no overburden. The dry portion was then seeded with a grass-legume mix. Work to the pond included contouring and adding a littoral zone to promote quality wetland establishment. A deep pocket was dug on the pond's east end to provide overwintering habitat for fish and amphibians.



## CAPITAL PAVING

### HONOURABLE MENTION

HOLMAN PIT  
TOWN OF GUELPH-ERAMOSA

Final rehabilitation on Holman Pit took place between November 2016 and June 2017 to return the site to agricultural use. Eight tri-axle loads of stones were removed from the site, side slopes were built to greater than 4:1, the topography was made more uniform, and deep ripping was conducted on the pit floor to make the land more accessible to farm equipment and amenable to crops. The rehabilitation took place over 8.01 hectares and required 26,000 cubic metres of topsoil spread to an average thickness of 350 millimetres. The land was seeded with a mix of timothy climax, brome grass common #1, red creeping fescue, pasture ryegrass, alfalfa, and kentucky bluegrass.

## CBM AGGREGATES – A Division of Votorantim Cimentos

SUNDERLAND PIT AREA 2  
TOWN OF BROCK

Area 2 of CBM Aggregates' Sunderland Pit was the site of this rehabilitation project. Work began on the 4.5-hectare project in June 2016 to grade the pit floor into a naturalized state. Overburden was stripped from the west side of the site's central pond, and three rock trucks were used to transport and dump approximately 40,000 cubic metres of overburden along the north extraction limit to establish the rough grade required for the slope, which was then graded. Following this, nearly 4,000 cubic metres of topsoil was pulled from a nearby stockpile and applied at an approximate depth of six inches. This was then graded and seeded with a standard MTO mix.



## CBM AGGREGATES – A Division of Votorantim Cimentos

SUNDERLAND PIT SOUTH PIT EAST SLOPE  
TOWN OF BROCK

This rehabilitation project focused on the east slope of the South Pit at CBM Aggregates' Sunderland Pit. It was conducted over 1.8 hectares and comprised the creation of a 3:1 side slope along the east slope. Approximately 9,000 cubic metres of overburden was brought in from a nearby stockpile and 31,000 cubic metres of material from an area in the north. Topsoil was also sourced from the northern area and spread onto the rehabilitated area at an approximate thickness of six inches. The newly treated site was then seeded with a standard MTO seed mix.



## CBM AGGREGATES – A Division of Votorantim Cimentos

WILROY BROOKS PIT  
TOWN OF HALTON HILLS

Rehabilitation at Wilroy Brooks Pit spanned 12.9 hectares of the 79.18-hectare site. Work started in 2005 and was completed in phases over the decade to make the land suitable for agricultural use. During the final contouring, material was moved from an on-site storage berm to create a 3:1 slope on the side slopes and a gentle slope on the pit floor. Topsoil was applied and the area was seeded with a grass-legume mix in the spring. Additional seeding was eventually added near the top of the south slope, and contouring occurred in August 2017 to blend phases 1 and 2, during which time the area was seeded with winter wheat.



## JAMES DICK CONSTRUCTION LIMITED

ALTON PIT  
TOWN OF CALEDON

James Dick Construction earned its award for rehabilitating 1.5 hectares of its Alton Pit. Trees were planted along the northern boundary and various species added to create a suitable Monarch butterfly habitat, the latter of which required seeding 0.26 hectares of land with a specially sourced butterfly seed mix. Grading took place over a couple of days using topsoil spread between thicknesses of six inches and one foot. The remaining area was seeded with an overseeding mixture comprised of perennial ryegrass. This was distributed both via spreader and by hand with help from University of Waterloo co-op students. Further tree planting is scheduled to take place in spring 2018.



## LAFARGE CANADA INC. – A Member of LafargeHolcim

FLAHERTY PIT  
TOWN OF CALEDON

The goal of this rehabilitation project was to transform extraction areas and faces at Flaherty Pit's central and west pits into agricultural and recreational land. The project took place over a total of 11.3 hectares of land and included work with Tri-City. They used three Caterpillar A30 rock trucks to deposit material over the site, and a Cat D5 dozer to complete the grading. Topsoil was spread over the area at depths from eight to 23 inches and a total of 47,000 cubic metres of material was moved. The final part of the project involved seeding the exposed area with a grass-legume seed mix and applying fibramulch fertilizer.



## LAFARGE CANADA INC. – A Member of LafargeHolcim

FONTHILL PIT  
TOWN OF PELHAM

Lafarge Canada's Fonthill Pit focused on 2.46 hectares for this rehabilitation, part of an ongoing project to turn the site back into a fruit orchard. The project was divided between Area 1 (1.78 hectares) and Area 2 (0.68 hectares). It required transporting and applying approximately 24,000 cubic metres of material. Area 1 was hydro-seeded in preparation for future tender fruit crops and Area 2 was seeded for stabilization. Niagara College Ecosystem Restoration graduate students joined Lafarge to research pollinator support and water management and later to help plant seed mixes to attract local pollinators.



## LAFARGE CANADA INC. – A Member of LafargeHolcim

ST. GERMAIN PIT  
TOWN OF UXBRIDGE

St. Germain Pit workers have been helping return former extraction areas and faces to natural recreation land. Rehabilitation of 1.11 hectares of the former pit face and floor is completed, while 3.97 hectares of land are still in the process of rehabilitation. In total, the project is rehabilitating three areas of the pit, on the north, west, and south walls. Today, the north wall has become a thickly vegetated slope, while rehabilitation continues on the west and south walls. The seed mix chosen for all the projects is a grass-legume mix of buckwheat, alfalfa, crown vetch, white clover, perennial rye, and tall fescue.







# PROPERTY ENHANCEMENT

The Property Enhancement Award recognizes operational best practices in a site's entrance, approach and perimeter screening, office and scalehouse areas, employee areas, plant appearance, environmental controls, truck and mobile equipment, and communicative signage. Sites that initially meet the minimum requirements in each of the aforementioned sections are awarded a plaque. Site operators are then provided with an opportunity to win a "gold" bar for each section by meeting the comprehensive list of criteria for each. A total of seven "gold" bars can be achieved.

SUPPORTED BY



**LAFARGE CANADA INC.**  
A Member of LafargeHolcim  
CAMBRIDGE PIT

## FOUR GOLD BARS:

- ▲ Entrance, Approach & Perimeter Screening
- ▲ Office & Scalehouse Areas
- ▲ Environmental Controls
- ▲ Communicative Signage

**MILLER PAVING LTD.**  
CARDEN QUARRY

## ONE GOLD BAR:

- ▲ Trucks & Mobile Equipment



**MILLER PAVING LTD.**  
PATTERSON QUARRY

## PLAQUE AND FOUR GOLD BARS:

- ▲ Entrance Approach & Perimeter Screening
- ▲ Office & Scalehouse Areas
- ▲ Employee Areas
- ▲ Communicative Signage

**NELSON AGGREGATE CO.**  
ONEIDA QUARRY

## TWO GOLD BARS:

- ▲ Employee Areas
- ▲ Communicative Signage





# STUDENT DESIGN COMPETITION



SUPPORTED BY

**DELIVERING  
CHOICE**

**rb RITCHIE BROS.**  
Auctioneers

**IRON  
PLANET**

rbauktion.com | IronPlanet.com

The Student Design Competition recognizes the most innovative and impressive designs for the rehabilitation of a former pit or quarry. This year, students were challenged to create site plans for James Dick Construction Ltd.'s Caledon Sand and Gravel Pit located in Caledon Village, Ontario.

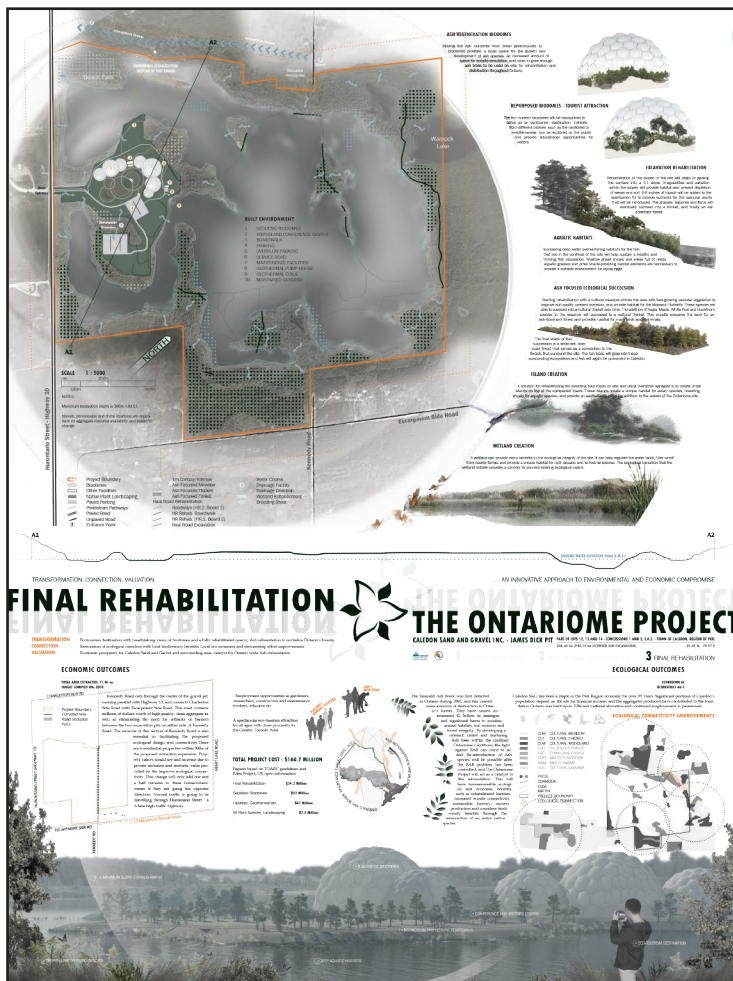

## 1ST PLACE (\$3,000) – The Ontariome Project

ALLISON GRAY, LAURA SWYERS,  
TREVOR WHITEHEAD - FANSHAW COLLEGE

Ecological renewal and economic success are the core objectives of this first-place entry. The Ontariome Project seeks to reintroduce Ash trees to the region and, over time, create bio domes for public viewing. It begins by growing Ash trees in controlled environments (aka 'structures') that take advantage of microclimate conditions on the rehabilitated pit landscape. As rehabilitation work progresses, the Ash trees are re-introduced into the wild and their structures are upgraded to bio domes featuring an Ash forest and other natural displays.

These bio domes would be open to the public, and entrance fees would fuel the site's ongoing operations and potentially create jobs in the Caledon community. Beyond this, The Ontariome Project envisions remaking other parts of the James Dick quarry into aquatic habitats and wetlands to support various animal species. Taken in its entirety, this student entry offers a detailed game plan for transforming the site into what the Fanshawe College team describes as an "ecotourism destination with breathtaking views of biomes and a rehabilitated quarry."

## 2nd Place (\$1,500) – Mainstream

ELIZABETH LATIF - FANSHAW COLLEGE

There are several elements at play in Mainstream, which re-imagines Caledon Sand and Gravel as both a tourist destination and an environmental asset. These elements include dedicated woodland habitats in the quarry's south end, rehabilitated meadows and wetlands, several strategies to enhance the site's biodiversity, and trails and amenities designed to connect future visitors with a revitalized natural environment.

Central to Mainstream's plans is the construction of an eco-park on the pit's west side. This interactive area features a central hub, education centre, and a lookout tower that draws its design inspiration from Caledon Sand and Gravel's processing machinery. According to the submission's in-depth plans, the eco-park would facilitate a wide range of activities (e.g., skating, canoeing, and cable-guided wakeboarding) as well as connections to the rehabilitated areas through a boardwalk and ample walking and biking trails.



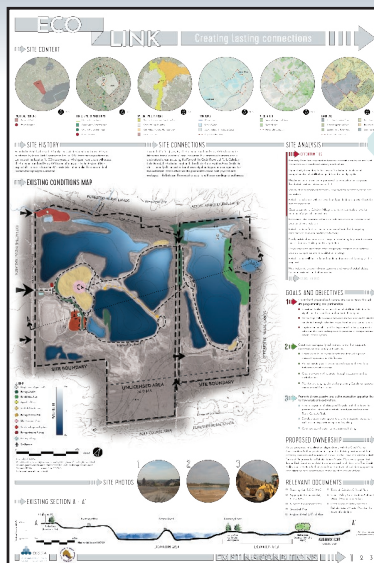

### 3rd Place (\$1,200) – EcoLink

RACHEL FRASER, ZIYI ZHANG, JERYN MACKEY - UNIVERSITY OF GUELPH

Rehabilitation, recreation, and connection are the central themes of EcoLink's vision. The submission outlines the development of physical and ecological links between the rehabilitated pit and its surrounding natural areas. It envisions new connections between the Kennedy Trail to the railway in the north and Bruce Trail to the south, the creation of trails to golf course paths, and passive trails throughout environmental policy areas, all to be developed in collaboration with the town of Caledon. The plan also suggests forming partnerships with aggregate companies to construct a linked network of rehabilitated paths throughout the site.

Community connections are a priority in this student submission. EcoLink's rehabilitated wetlands, meadows, and open water sources will allow visitors to enjoy natural activities like recreational fishing, biking, hiking, and boating. Additional features, like a wetland boardwalk, eco-bridge, multiple lookouts and a stylish Central Earthwork attraction, round out this holistic vision.

### 4th Place (\$900) – Stoneshore Lake Conservation Area

ADAM PERSI, DANIEL CORNACCHIA, KEVIN WU - UNIVERSITY OF GUELPH

This submission sees the James Dick Caledon gravel pit repurposed as an overnight vacation hotspot. Leveraging the site's size, access to water, and unique topographical features, the plans call for eco-lodges to be built around a waterfront to provide visitors with access to scenic accommodations and a wide range of activities. These include swimming, canoeing, hiking, fishing, and even the opportunity to reach new heights with zip lines and a tree-top adventure theme park.

Key to Stoneshore Lake Conservation Area's plans is creating a natural environment worth visiting. To that end, the submission calls for the development of grasslands, wetlands, aquatic environments, and habitats for a number of species to make the site an attractive ecotourist destination. Furthermore, the plan is designed to generate economic benefits by opening its event centre to public rental, offering services to eco-lodge guests, selling equipment rentals, and hosting outdoor attractions.

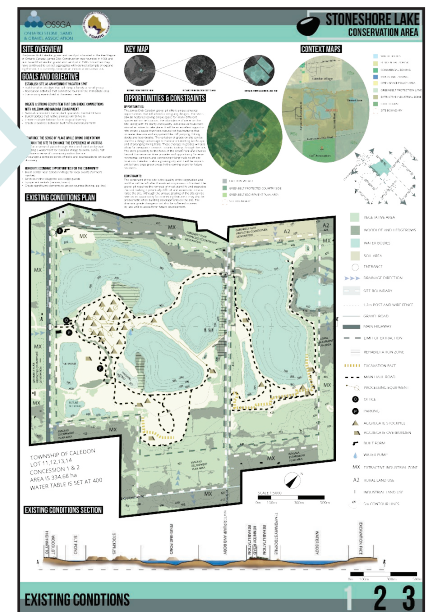

### Honourable Mention (\$500) – Long Haul Drift

RICHARDO DA CUNHA TERRA SANTOS, LESLIE NORRIS - UNIVERSITY OF TORONTO

Long Haul Drift proposes using clean fill from development projects in the Greater Toronto Area to build the terrain for a Rubble Beach Recreation Area. In doing so, the Caledon Pit would become a natural tourist destination with beaches, forests, marshes, and ample outdoor recreation activities. By giving new use to clean waste and serving as a template for sustainable waste management in urban areas, this student submission seeks to transform the site into one where "material flows and human flows converge."

### Honourable Mention (\$500) – Trail as Terrain

MEIKANG LI, ERIC WONG - UNIVERSITY OF TORONTO

This student entry places Caledon Village at the heart of a trail network which, over time, will connect the community to new parks and outdoor spaces as the lands around those trails are rehabilitated. It includes the development of a bridging structure in the early phases that will help the surrounding landscape heal and facilitate greenspace development in the future. By establishing trails for future outdoor spaces, Trail as Terrain aims to rejuvenate the pit and drive economic benefits that will blaze new trails.

